

# Balancing valves, steel, reduced bore

welding / welding, EN (DIN), DN 15-300

Body	DN 15-300 Steel, P235GH (1.0345)
Ball	DN 15-300 Stainless steel, X5CrNi18-10 (1.4301)
Ball seal	DN 15-300 PTFE+GF
Stem	DN 15-300 Stainless steel, X8CrNiS18-9 (1.4305)
Stem seal	DN 15-300 FPM
Measuring block	DN 15-300 Type Oras, brass
Operation	DN 15-150 With zinc-plated steel handle DN 200-300 Valve is equipped with manual gear



## Operation conditions

-30 °C – +200 °C

Below 0 °C contact manufacturer

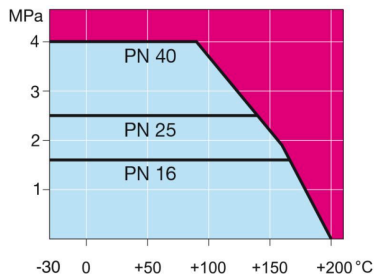

Not for steam

DN 15-150

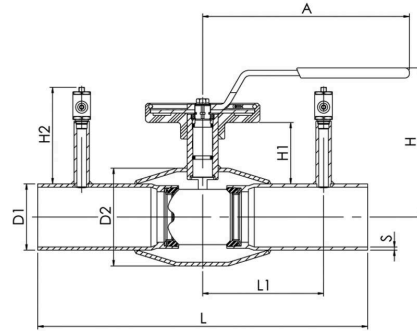

DN 200-300

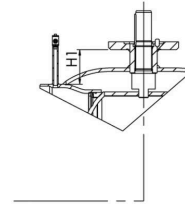

DN	PN	Product no. Vexve	A	D1	D2	H	H1	H2	L	L1	S	kg
15	40	140015	145	21.3	42.4	134	50	93	230	65	2.3	1.3
20	40	140020	145	26.9	42.4	136	53	93	230	65	2.3	1.4
25	40	140025	145	33.7	48.3	142	55	93	230	65	2.6	1.7
32	40	140032	145	42.4	60.3	144	53	93	260	80	2.6	1.8
40	40	140040	188	48.3	70.0	143	60	93	260	80	2.6	2.6
50	40	140050	188	60.3	88.9	149	60	93	300	100	2.9	3.5
65	25	140065	280	76.1	101.6	160	58	108	300	110	2.9	4.8
80	25	140080	280	88.9	121.0	173	64	108	300	110	3.2	6.1
100	25	140100	280	114.3	146.0	219	98	130	325	122.5	3.6	9.4
125	25	140125	400	139.7	177.8	253	100	130	325	137.5	4	16.2
150	25	140150	600	168.3	219.1	276	110	130	350	150	4,5	21.3
200	25	140200		219.1	273.0		72	128	400	180	4.5	45.0
250	25	140250		273.0	355.6		88	128	530	225	5	89.0
300	25	140300		323.9	457.0		112	128	550	245	5,6	140.0