

Instrument Tee with 2" Branch

PTFE-Lined

Housing Materials

FAB STEEL = Housing fabricated from pipe and/or weld fittings

Flange Materials

CS = ASTM A105

FV = Full Vacuum

*Nominal ID. For exact ID to determine if an instrument will fit in the bore, field measurement is necessary.

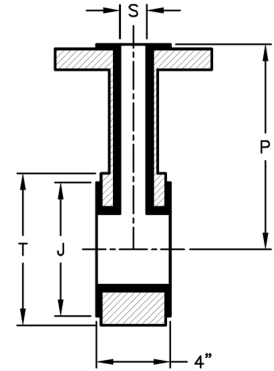

150lb. Flanged									
Size (NPS)	Part Numbers	Dimensions (in.)				Housing Material	Flanges		Vacuum Rating (in. Hg/°F)
		P	T	J	S*		Material	R=Rotating F=Fixed	
2	T400M300ZM220	5 9/16	4 1/5	3 5/8	1 25/32	FAB STEEL	CS	F	FV/450
	T400M300ZR220	4 1/2			1 5/8			R	
3	T400M300ZS320	6 5/16	5 3/8	5	1 7/8			F	
	T400M300ZR320	5 1/2			1 5/8			R	
4	T400M300ZM420	7 1/16	6 7/8	6 3/16	1 25/32			F	
	T400M300ZR420	6 1/2			1 5/8			R	
6	T400M300ZS620	8 1/16	8 3/4	8 1/2	1 7/8			F	
	T400M300ZR620	8			1 5/8			R	
8	T400M300ZS820	9 5/16	11	10 5/8	1 7/8			F	
	T400M300ZR820	9			1 5/8			R	
10	T400M300ZSE20	10 3/8	13 3/8	12 3/4	1 7/8			F	FV/450
	T400M300ZRE20	11	13 1/4		1 5/8			R	No Vacuum
12	T400M300ZSF20	11 7/8	16 1/8	15	1 7/8			F	FV/450
	T400M300ZRF20	12	16		1 5/8			R	No Vacuum