

Instrument Tee with 1" Branch

PTFE-Lined

Housing Materials

FAB STEEL = Housing fabricated from pipe and/or weld fittings

DI = ASTM A395 Cast Ductile Iron

Flange Materials

CS = ASTM A105

DI = ASTM A395 Cast Ductile Iron

FV = Full Vacuum

*Nominal ID. For exact ID to determine if an instrument will fit in the bore, field measurement is necessary.

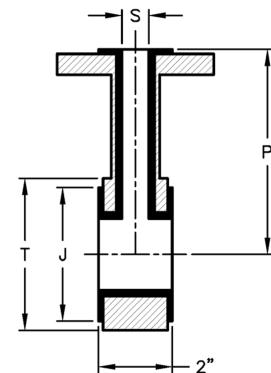

150lb. Flanged									
Size (NPS)	Part Numbers	Dimensions (in.)				Housing Material	Flanges		Vacuum Rating (in. Hg/°F)
		P	T	J	S*		Material	R = Rotating F = Fixed	
1	T400M100VN110	3 1/2	2 5/8	2	25/32	DI	DI	F	FV/450
	T400M300ZN110		2 13/16			FAB STEEL	CS	R	
1.5	T400M100VNB10	4	3 3/8	2 7/8	25/32	DI	DI	F	
	T400M300ZRB10					5/8	FAB STEEL	CS	
2	T400M100VN210	5 9/16	4 1/5	3 5/8	25/32	FAB STEEL	DI	F	
	T400M300ZR210	4 1/2					5/8	CS	
3	T400M100VN310	6 5/16	5 3/8	5	25/32	DI	DI	F	
	T400M300ZR310	5 1/2				5/8	FAB STEEL	CS	
4	T400M100VN410	7 1/16	6 7/8	6 3/16	25/32	DI	DI	F	
	T400M300ZR410	6 1/2				5/8	FAB STEEL	CS	
6	T400M100VN610	8 1/16	8 3/4	8 1/2	25/32	DI	DI	F	
	T400M300ZR610	8				5/8	FAB STEEL	CS	
8	T400M300ZM810	9 5/16	11	10 5/8	25/32	FAB STEEL	CS	F	
	T400M300ZR810	9						5/8	R
10	T400M100VME10	10 3/8	13 3/8	12 3/4	25/32	FAB STEEL	CS	F	FV/450
	T400M300ZRE10	11	13 1/4					5/8	R
12	T400M100VMF10	11 7/8	16 1/8	15	25/32	FAB STEEL	CS	F	FV/450
	T400M300ZRF10	12	16					5/8	R

300lb. Flanged - Fab Steel Body Only									
Size (NPS)	Part Numbers	Dimensions (in.)				Housing Material	Flanges		Vacuum Rating (in. Hg/°F)
		P	T	J	S*		Material	R = Rotating F = Fixed	
1	T400MA00YM110	3 1/2	2 5/8	2	25/32	FAB STEEL	CS	F	FV/450
1.5	T400MA00YMB10	4	3 3/8	2 7/8	25/32			F	
2	T400MA00YR210	4 1/2	4 1/8	3 5/8	5/8			R	
3	T400MA00YR310	5 1/2	5 3/8	5	5/8				
4	T400MA00YR410	6 1/2	6 7/8	6 3/16	5/8				
6	T400MA00YR610	8	8 3/4	8 1/2	5/8				
8	T400MA00YR810	9	11	10 5/8	5/8				