

Instrument Tee with 1.5" Branch PTFE-Lined

Housing Materials

FAB STEEL = Housing fabricated from pipe and/or weld fittings

DI = ASTM A395 Cast Ductile Iron

Flange Materials

CS = ASTM A105

DI = ASTM A395 Cast Ductile Iron

FV = Full Vacuum

*Nominal ID. For exact ID to determine if an instrument will fit in the bore, field measurement is necessary.

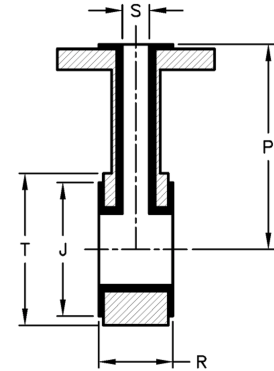

150lb. Flanged													
Size (NPS)	Part Numbers	Dimensions (in.)					Housing Material	Flanges		Vacuum Rating (in. Hg/°F)			
		P	R	T	J	S*		Material	R=Rotating F=Fixed				
1.5	T400M300ZMBB0	4	3	3 3/8	2 7/8	1 5/16	FAB STEEL	CS	F	FV/450			
	T400M300ZRBB0		4			1 1/8			R				
2	T400M300ZM2B0	5 9/16	3	4 1/5	3 5/8	1 5/16			DI		DI	F	
	T400M300ZR2B0	4 1/2	4		1 1/8	R							
3	T400M100VN3B0	6 5/16	3	5 3/8	5	1 5/16		FAB STEEL			CS	F	
	T400M300ZR3B0	5 1/2	4		1 1/8	R							
4	T400M300ZM4B0	7 1/16	3	6 7/8	6 3/16	1 5/16			DI			DI	F
	T400M300ZR4B0	6 1/2	4		1 1/8	R							
6	T400M300ZS6B0	8 1/16	3	8 3/4	8 1/2	1 5/16	FAB STEEL				CS		F
	T400M300ZR6B0	8	4		1 1/8	R							
8	T400M300ZS8B0	9 5/16	3	11	10 5/8	1 5/16			DI			DI	F
	T400M300ZR8B0	9	4		1 1/8	R							
10	T400M300ZSEB0	10 3/8	3	13 3/8	12 3/4	1 5/16		FAB STEEL		CS	F		
	T400M300ZREB0	11	4	13 1/4		1 1/8					R		
12	T400M300ZSFB0	11 7/8	3	16 1/8	15	1 5/16			DI		DI	F	
	T400M300ZRFB0	12	4	16		1 1/8						R	

300lb. Flanged - Fab Steel Body Only										
Size (NPS)	Part Numbers	Dimensions (in.)					Housing Material	Flanges		Vacuum Rating (in. Hg/°F)
		P	R	T	J	S*		Material	R = Rotating F = Fixed	
1.5	T400MA00YSBB0	4	3	3 3/8	2 7/8	1 11/32	FAB STEEL	CS	F	FV/450
3	T400MA00YS3B0	6 5/16	3	5 3/8	5	1 11/32				
4	T400MA00YS4B0	7 1/16	3	6 7/8	6 3/16	1 11/32				
6	T400MA00YS6B0	8 1/16	3	8 3/4	8 1/2	1 11/32				
8	T400MA00YS8B0	13 3/8	3	11	10 5/8	1 11/32				